

ETCH

Technical Specifications

ETCH is a mobile whiteboard with multiple surface options including whiteboard, pinboards and shelves for a flexible, productive work environment. The tapered design of ETCH complements the RETREAT product range and nests neatly in between when not in use.

ETCH is available in a variety of combinations including:

- Magnetic Whiteboard
- Pinboard
- Cantilever Planter
- Magnetic Whiteboard / Pinboard
- Magnetic Whiteboard / Cantilever Planter
- Pinboard / Cantilever Planter



Square
Bear

ETCH
TECHNICAL SPECIFICATIONS | sales@square-bear.com
www.square-bear.com

Product Data

ETCH WHITEBOARD

Full panel magnetic whiteboard.

Product dimensions

Overall dimensions 1060W x 500/190D x 1905mmH
Whiteboard panel 1000W x 1568mmH

Structure

Plywood panels 32mm hoop pine plywood
Whiteboard Magnetic whiteboard substrate
Acoustic inlay PET panel

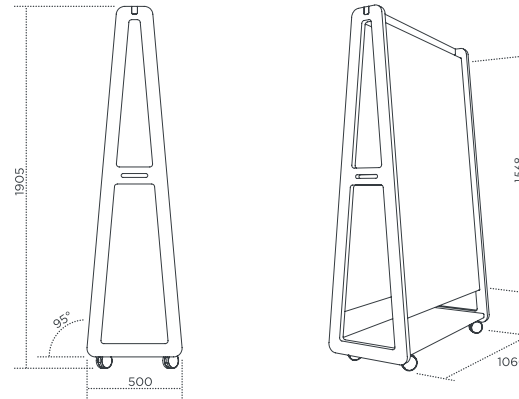

ETCH PINBOARD

Full panel pinboard.

Product dimensions

Overall dimensions 1060W x 500/190D x 1905mmH
Pinboard panel 1000W x 1568mmH

Structure

Plywood panels 32mm hoop pine plywood
Pinboard PET panel
Acoustic inlay PET panel

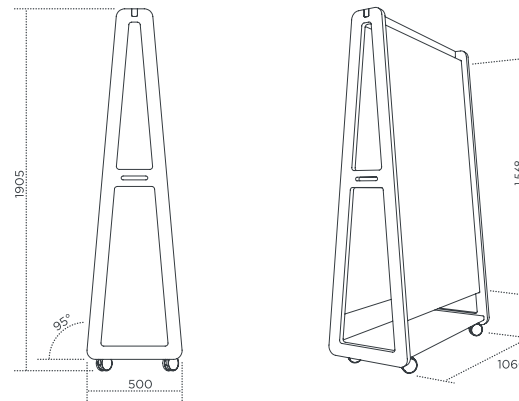

Product Data

ETCH HALF WHITEBOARD

Half panel magnetic whiteboard with marker tray.
Half panel pinboard.

Product dimensions

Overall dimensions 1060W x 500/190D x 1905mmH
Whiteboard panel 1000W x 840mmH

Structure

Plywood panels 32mm hoop pine plywood
Whiteboard Magnetic whiteboard substrate
Pinboard PET panel
Acoustic inlay PET panel

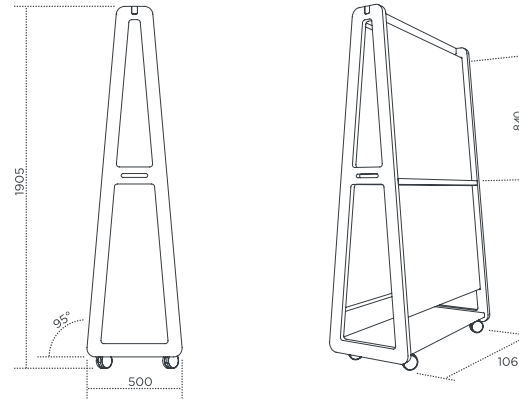

ETCH CANTILEVER PLANTER

Blending ETCH with our 100 ACRE product range we have designed ETCH CANTILEVER PLANTER to provide a whiteboard on one side and a planter panel on the other. Mobile castors provide the option to move the product around the office for flexible team-based task work or to create privacy screening and green walls.

Product dimensions

Overall dimensions 1060W x 500/190D x 1905mmH
Plywood cantilever panel 1000W x 1568mmH
Pot size 150mm DIA

Structure

Plywood panels 32mm hoop pine plywood
Acoustic inlay PET panel

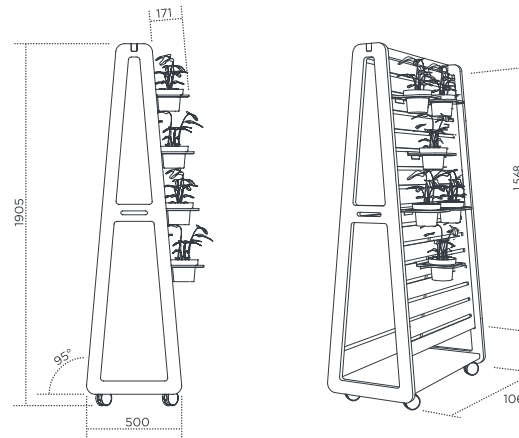

Product Data & Finishes

Product data - common for all products

PET

Composition	100% PET, 60-68% recycled
Sustainability	Greentag certified. Greenrate level: A
VOC emission	<0.004mg/m ² /hr

Cleaning

PET / Upholstery	Refer to product care and maintenance guide
Timber	Refer to product care and maintenance guide

Timber finishes



Natural

Black Stain

Pinboard panel finishes

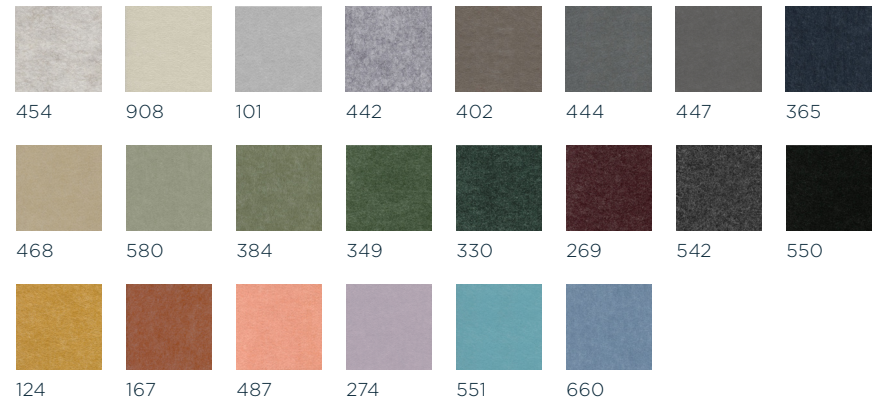

*Contact Square-Bear Acoustics for custom colour options.

SQUARE BEAR

© Copyright 2021

All Rights Reserved

HEAD OFFICE

Unit 6/80 Jedda Road, Prestons

New South Wales 2170, Australia

P: +61 (0)2 9189 1444

sales@square-bear.com

SYDNEY SHOWROOM

120 Bourke Street, Woolloomooloo

New South Wales 2011, Australia

www.square-bear.com