

5924

Design By Ichiro Iwasaki

Flat is a large ceiling lamp made up of horizontal discs at various heights that create planes of reflected light. The discs are self-illuminated by reflected light. The Flat ceiling light has a strong graphic quality, combining structure and functionality.

## Model Sheet

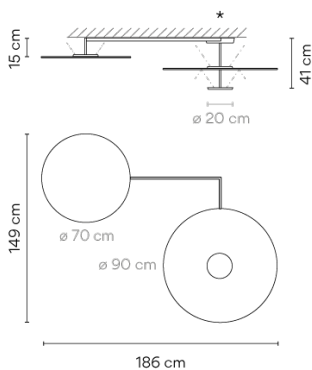

**Finish**

- 73 White, Grey L1  
NCS S 0300-N, NCS S 1000-N
- 10 White  
NCS S 0300-N
- 72 White, Green L1  
NCS S 0300-N, NCS S 4005-G80Y

**LED temperature color** 2700 K / 3500 K

**Dimming** Casambi / Push; 1-10V; DALI

**Installation type** Surface Canopy

**Materials**

- Ceiling rose: Steel
- Reflector: Aluminum
- Body: Steel
- Head: Aluminium

**Light source** 3 x LED PLATE 25W 700mA



**LED** CRI>90 10440 lm 139.20  
2700 K / 3500 K

**Driver** Constant Current 700 110~240  
V V 50~60 Hz HZ



**Application** Ceiling Lamps

**Packaging**

- 1 Box
- 1.275 m x 1.06 m x 0.46 m
- Gross weight 28.6
- Net weight 19.98
- Vol. 0.6216

## Lighting effect

## Surface Grazer

Creation of visual hierarchies through projected light, emphasising the materiality and texture of the surrounding environment

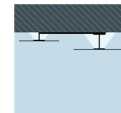

## Photometric Data

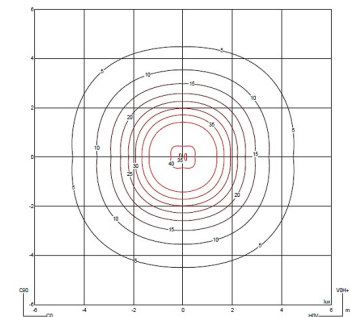
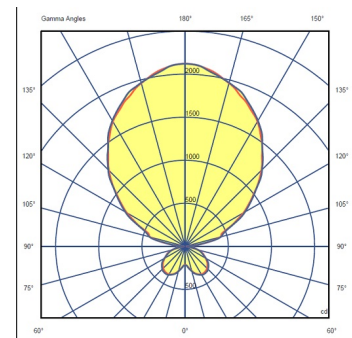

**Efficiency** 88.00 lm/W  
**Coordinate System** CG  
**Total Flux** 7154.22 lm  
**Maximum Value** 2122.35 cd

## Other Applications

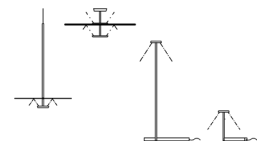

All of our products come with a five-year warranty. Check our legal terms at [www.vibia.com/warranty](http://www.vibia.com/warranty)

Vibia Lighting, S.L.U.

**Office / Oficina**  
Progrés 4-6. 08850 Gavà. Barcelona, Spain.

**International** T +34 934 796 971  
**Spain / Portugal** T +34 934 796 970

[customer.service@vibia.com](mailto:customer.service@vibia.com)  
[vibia.com](http://vibia.com)